

CAMPUS PROJECT INTRO  
FEBRUARY 2024

Jean Kim, School Founder  
Arlene Tendick, Campus Project Community Outreach



CAMBRIDGE



# Project Location

Cambridge School recently purchased the vacant parcel at Coyote Bush Drive and Templeton Street in Del Sur with plans to build a new school campus.

- Purchased parcel amid stiff competition
- Zoned CC 4-5
- Allows for a school





# Project Milestones

The land use planning process can be lengthy. We encourage you to be part of the dialogue as we work to bring our vision to fruition.

DEC. 2023

Application Submittal

- Intro postcard

JAN. - FEB. 2024

Community Engagement Starts

- Launch website
- Community Meetings
- Aggregate feedback
- Refine application

SPRING 2024

Resubmit Application

- Multiple submittals as needed

Q1 2025

Inform + Update

- Multiple submittals as needed

City Approval of CUP

# Preliminary Vision

This new campus home will provide the space needed to better support our mission to educate the next generation of young people to think well, love rightly, and live wisely.

- Address the various challenges we face on our current campus.
- Reinforce our already strong academic programs
- Allow us to grow our co-curricular programs
- Provide the space and facilities needed to better support our mission





# Preliminary Vision

This new campus home will provide the space needed to better support our mission to educate the next generation of young people to think well, love rightly, and live wisely.

## The preliminary vision includes:

- Spacious classrooms
- Track and field
- Multi-Purpose Building for co-curriculars and enrichment activities
- Ample office space and faculty lounge
- A dedicated library with art, music, science space
- Improved circulation for pick up and drop off
- Landscape buffers





# West Elevation





# Entry View



KEY MAP





# Central Plaza View



KEY MAP





# Multi Purpose Building View

(from Plaza)



KEY MAP





# South East View

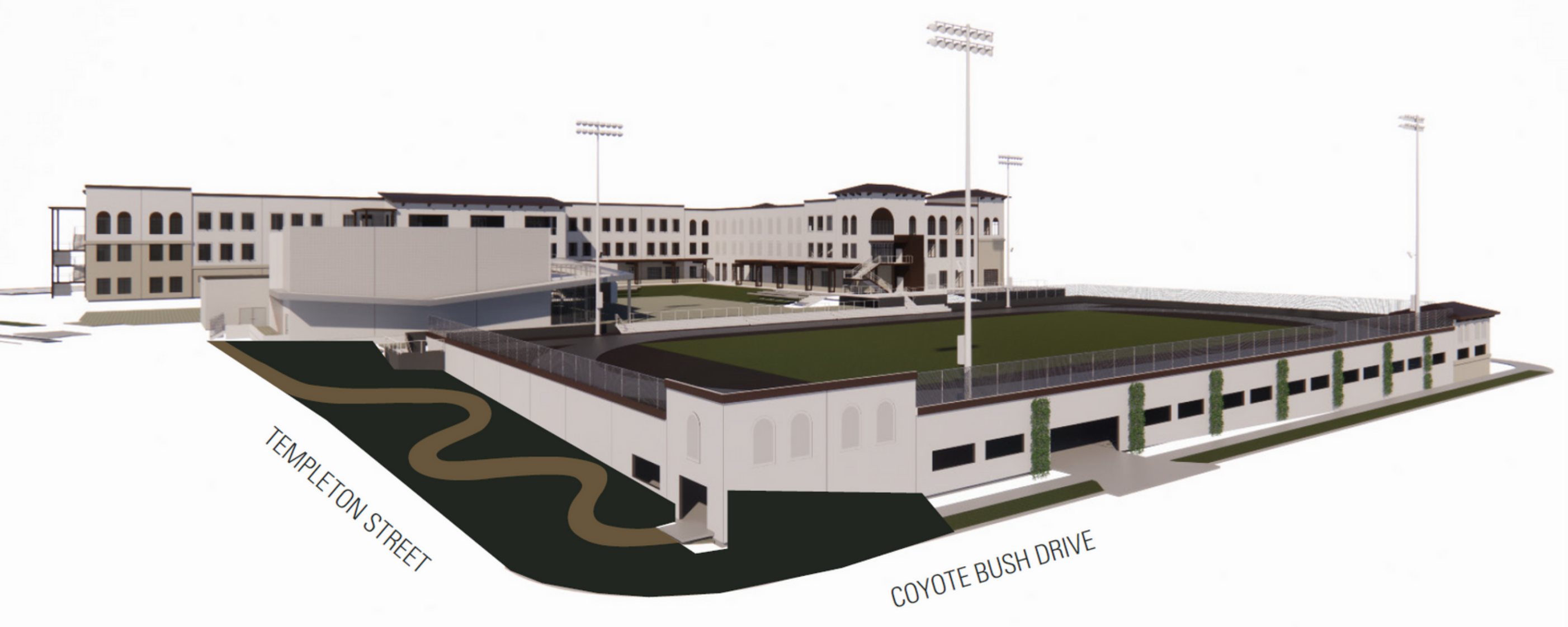

KEY MAP





# Summary of Objectives

- Address the various challenges we face on our current campus
- Reinforce our already strong academic programs
- Allow us to grow our co-curricular programs
- Provide the space and facilities needed to better support our mission



# Next Steps

- Collect feedback
- Host info meeting for public
- Refine and resubmit application

THANK YOU.

Join the project email list to be notified of project milestones and opportunities to participate

[www.cambridgeclassical.org/new-campus](http://www.cambridgeclassical.org/new-campus)



CAMBRIDGE



# Facilities Overview

The upper and grammar school classrooms will be come together at campus-wide facilities.

- ADMINISTRATION
- CAMPUS WIDE
- GRAMMAR SCHOOL
- UPPER SCHOOL

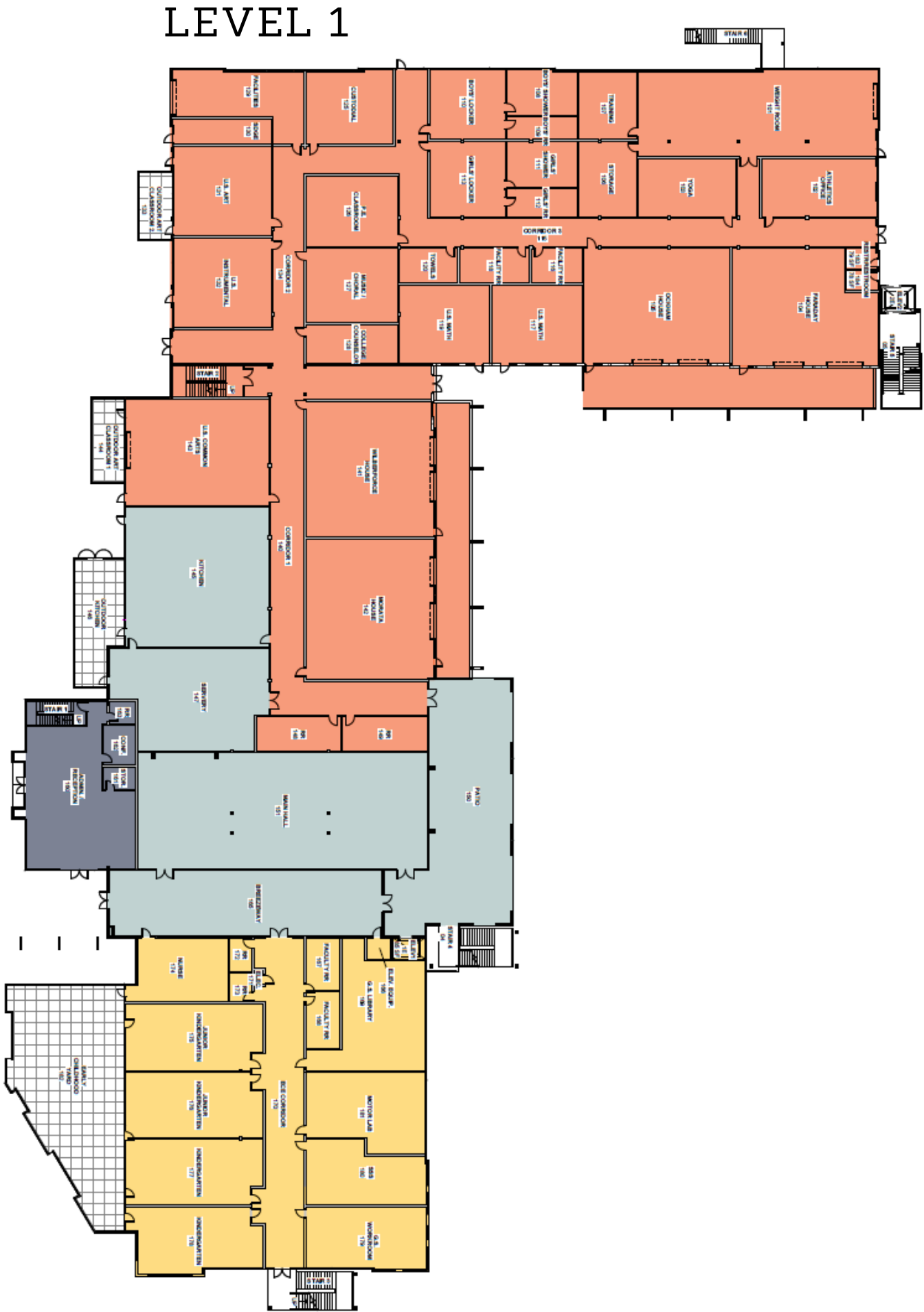

**KEY MAP**





# Facilities Overview

The upper and grammar school classrooms will be come together at campus-wide facilities.

- ADMINISTRATION
- CAMPUS WIDE
- GRAMMAR SCHOOL
- UPPER SCHOOL

KITCHEN  
 SERVERY  
 MAIN HALL  
 FRONT OFFICE  
 PATIO

LEVEL 1

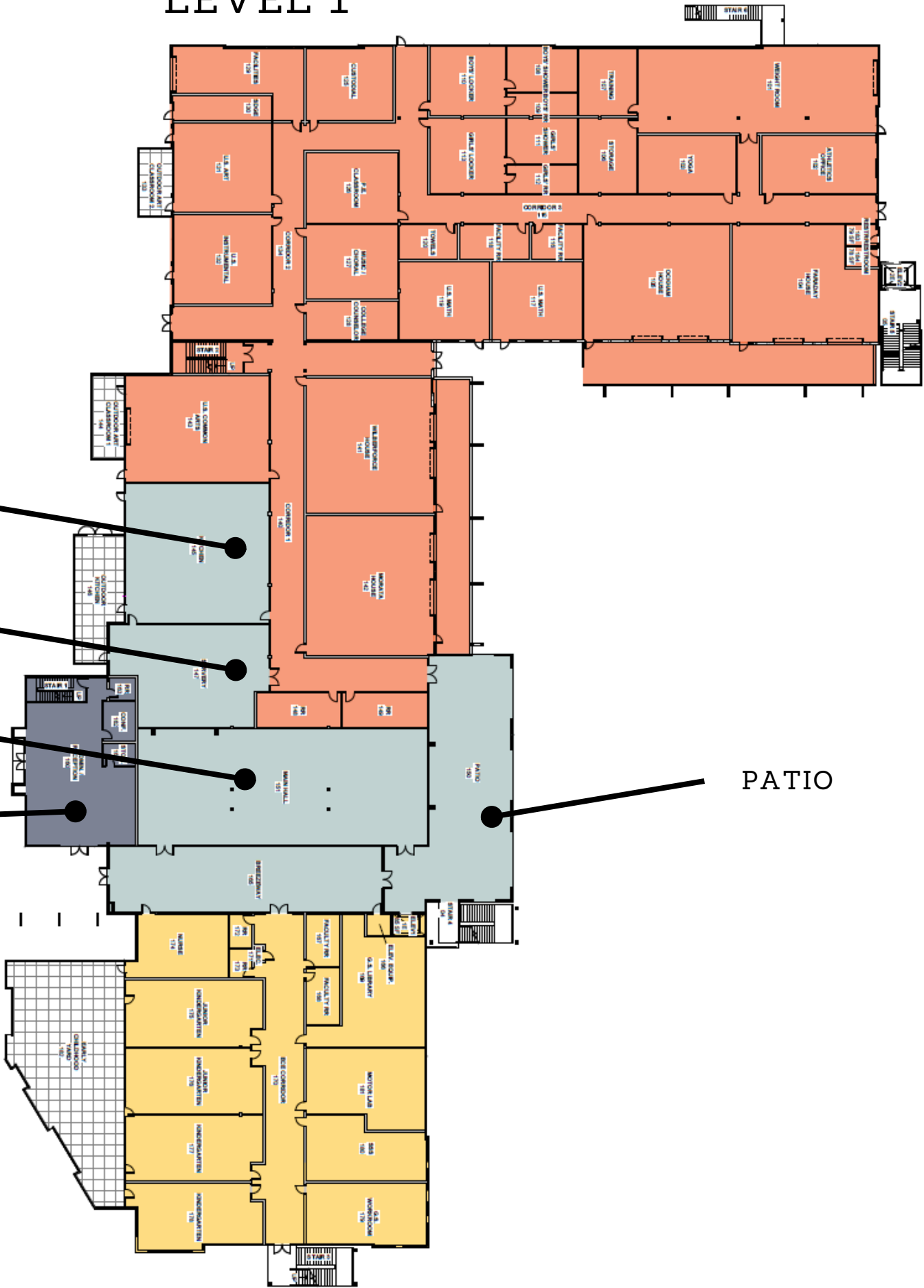

KEY MAP





# Facilities Overview

The upper and grammar school classrooms will be come together at campus-wide facilities.

- ADMINISTRATION
- CAMPUS WIDE
- GRAMMAR SCHOOL
- UPPER SCHOOL

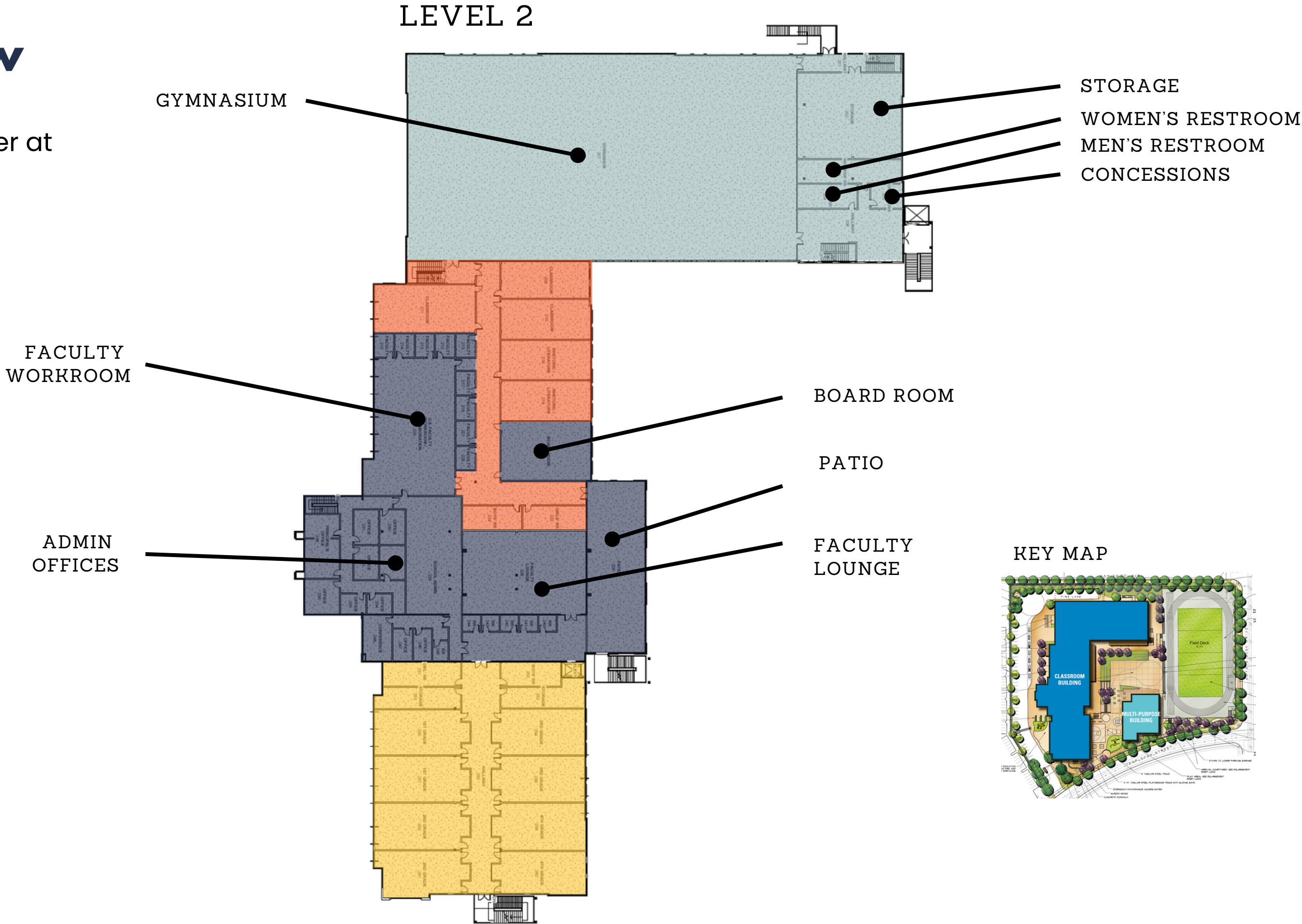



# Facilities Overview

The upper and grammar school classrooms will be come together at campus-wide facilities.

- ADMINISTRATION
- CAMPUS WIDE
- GRAMMAR SCHOOL
- UPPER SCHOOL

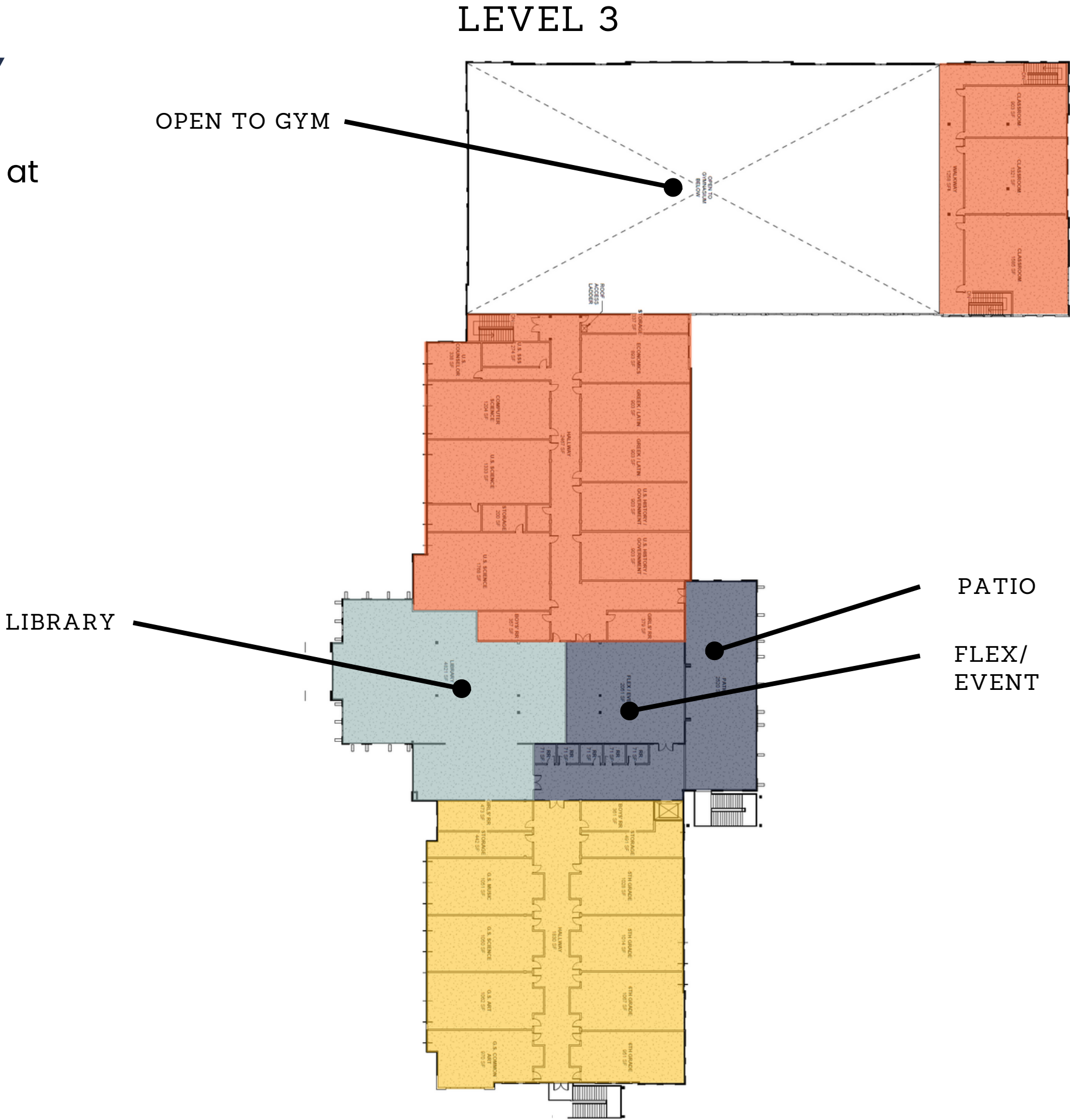

KEY MAP

